



Friday 9th January 2026

Year 10 Parent/Carer Subject Consultation Event
Thursday 22nd January 2026 – 3.45 pm – 7.30 pm

Dear Parents and Carers

I am pleased to invite you to attend the Year 10 parent/carers consultation afternoon on Thursday 22nd January.

Consultation events play an important role in our partnership, and we are keen for all parents and carers to attend, ideally with your child.

You are able to book five-minute appointments with your child's teachers. Details of how to do this are outlined below. Where a group is taught by more than one teacher, we generally identify a "lead" teacher who will meet parents/carers on behalf of the teaching team. This enables more families to secure appointments. During each appointment, conversations will focus on strategies to support your child in making the greatest progress, as well as feedback on classwork and homework completed to date.

Senior staff who do not teach Year 10 will be available for drop-in discussions (not bookable in advance) if there are any additional matters you wish to raise.

If you are unable to attend for any reason, please let us know. ***Should you require any support such as assistance with transport challenges, mobility considerations, or translation services we will do our best to help. Please email bkent@wootton.beds.sch.uk***

Parking

Due to the ongoing building work in preparation for Years 7 and 8 joining us in September 2026, parking on site is more limited than usual. If you live locally and are able to do so, we kindly ask that you walk to the school or arrive in one vehicle.

For those arriving by car, parking will be available in the rear car parks located by the tennis courts and the 4G pitch and at the front of school (**please see school map overleaf**). A member of staff will be positioned at the tennis courts gate to welcome parents and carers. Additional parking is also available along the road to the side of the school, with access through the side gate, where another member of staff will be present to greet you.

Please note that the main Reception will **not be open**, and access to the event will not be available through this entrance.

We recommend that you arrive 15 minutes before your first appointment so that you can make your way to the sports hall given the current parking restrictions mentioned above.



Wootton Upper School

Part of Wootton Academy Trust



Wootton Upper School

Site Plan

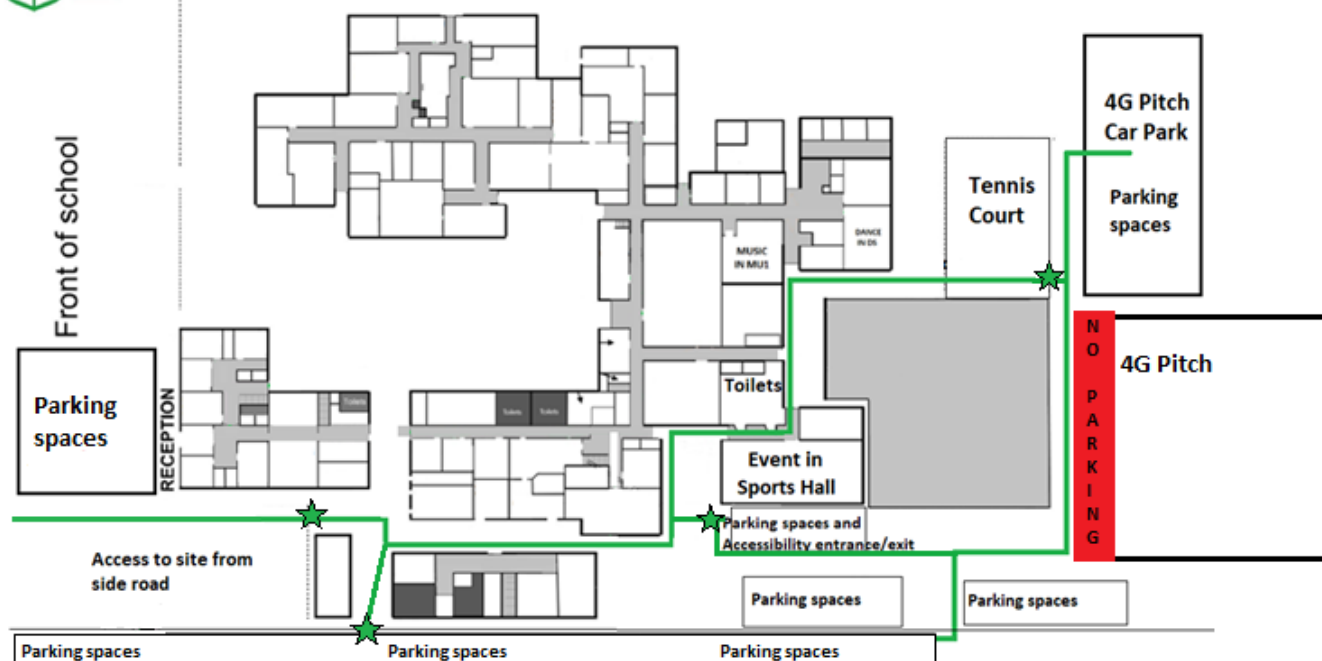

Map Key



The stars on the map above indicate the entrance and exit points to/from the school site

HOW TO BOOK APPOINTMENTS

Please book your appointments through the online system, you can do this by logging on to <https://woottonupperschool.schoolcloud.co.uk/>. The booking system will open at 9am on Monday 12th January and close at 12pm on Thursday 22nd January.

To log on you will need your own email address and the date of birth (there will be a drop-down menu available to select this from) of the pupil you are booking appointments for. If you have any difficulties with the booking process, please contact Wootton Upper School reception between (8.30am–2.30pm) on 01234 767123.

If you do not have access to the internet, please contact the school in order that alternative arrangements can be made.

We are really looking forward to meeting you face-to-face at the event.

Yours sincerely

Miss Anna Burnham
Deputy Headteacher